

LOCATED IN THE NW 1/4 OF THE NW 1/4 OF SECTION 15, TOWN 1 NORTH, RANGE 17 EAST
TOWN OF LINN, WALWORTH COUNTY, WISCONSIN

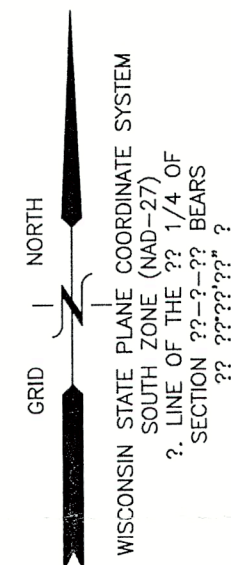

LANDS SURVEYED
LOTS 1-2
25,962 SQ FT
(0.60 ACRES)

LEGEND

- = IRON PIPE FOUND 1 3/8" O.D.
● = IRON REBAR FOUND 3/4" O.D.
⊖ = UTILITY POLE
{xxx} = RECORDED AS
FF = FIRST FLOOR ELEVATION

NOTE: COPIES OF THIS MAP TO WHICH THE FOLLOWING CERTIFICATE WILL APPLY SHOW THE SURVEYOR'S ORIGINAL SEAL AND SIGNATURE IN RED INK. COPIES BY ANY OTHER MEANS MAY HAVE ALTERATIONS WHICH DO NOT REPRESENT THE SURVEYOR'S WORK PRODUCT.

I HEREBY CERTIFY THAT THE ABOVE DESCRIBED PROPERTY HAS BEEN SURVEYED UNDER MY DIRECTION AND THAT THE ABOVE MAP IS A TRUE REPRESENTATION THEREOF AND SHOWS THE SIZE AND LOCATION OF THE PROPERTY AND ITS EXTERIOR BOUNDARIES. THIS SURVEY IS MADE FOR THE USE OF THE PRESENT OWNERS OF THE PROPERTY, AND ALSO THOSE WHO PURCHASE, MORTGAGE, OR GUARANTEE THE TITLE THERETO WITHIN ONE YEAR FROM THE DATE HEREOF.

DATED: 11/15/2022

CHRISTOPHER A. HODGES P.L.S. 2760

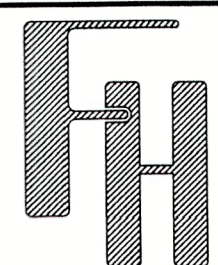
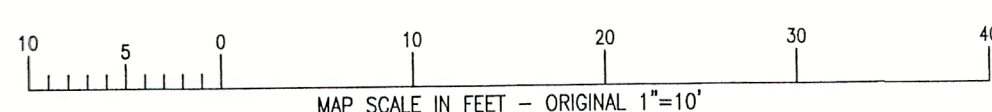
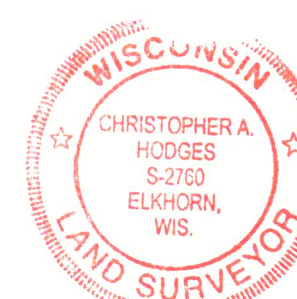
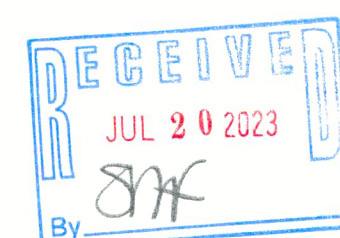

AS-BUILT SURVEY

N1666 LINN ROAD
LAKE GENEVA, WI 53147

— WORK ORDERED BY —
RONALD HENDRICKSON
N1666 LINN ROAD
LAKE GENEVA, WI 53147

FARRIS, HANSEN & ASSOCIATES, INC.

ENGINEERING — ARCHITECTURE — SURVEYING

7 RIDGWAY COURT P.O. BOX 437
ELKHORN, WISCONSIN 53121

OFFICE: (262) 723-2098 FAX: (262) 723-5886

REVISIONS

6/13/2023 - DHC
ADDITION AS-BUILT

PROJECT NO.
10801

DATE
11/15/2022

SHEET NO.
1 OF 1

C:\Projects\10801\ACAD\10801.dwg

ILGT-13B

117-4786